

# Instructions for Dot Shortcuts

## 1. Settings

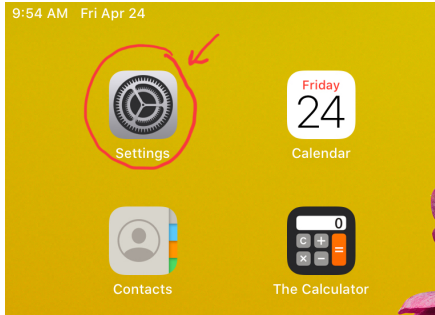

## 2. Click on Accessibility

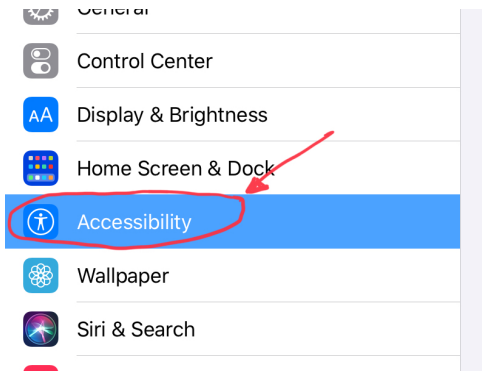

## 3. Click on Touch

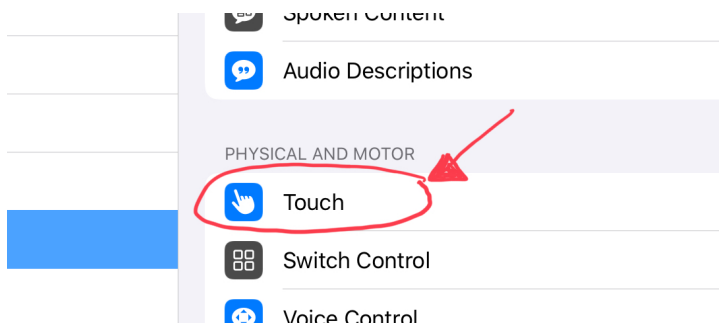

## 4. Click on Assistive Touch on

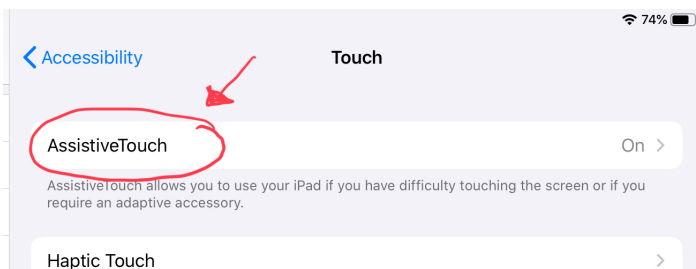

## 5. Click on Customize Top Level Menu

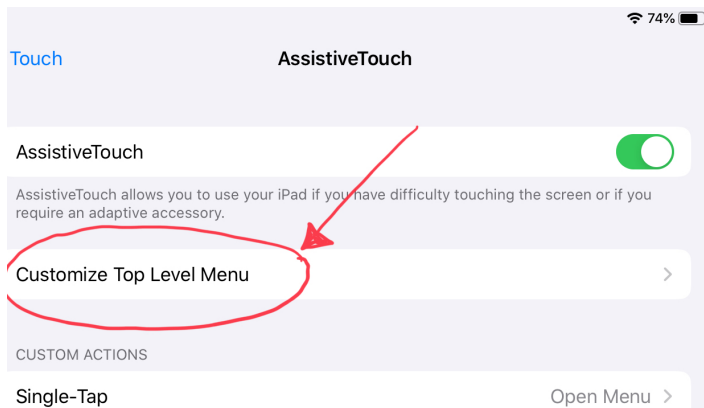

## 6. Change to 4 icons

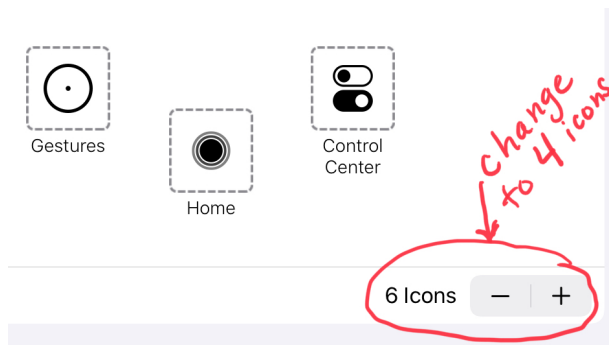

## 7. Click on squares and change each one to these shortcuts: Screen shot, Reset, Multitasking, Screen Speak

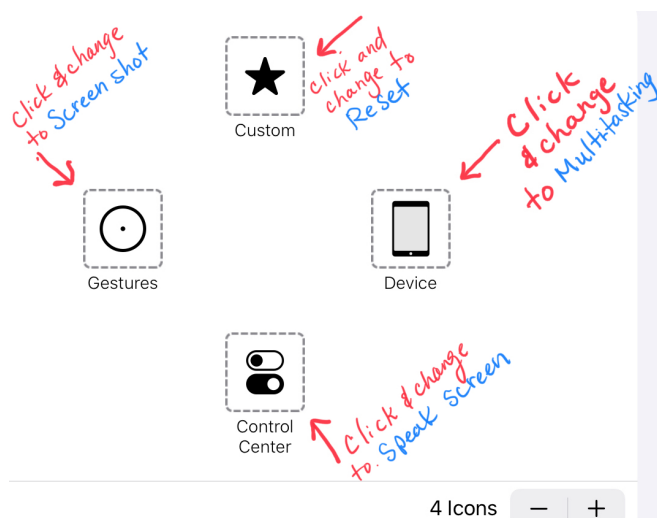

8. Click on Home Button
9. Click on Grayed Out Dot on Home Screen to access shortcuts.

